

CERTIFIED LAND CORNER RESTORATION

Index No. R-23

State of Wisconsin }
County of LANGLADE } ss.

I, WILLIAM F. KELLY, do hereby certify that on the 12th day of Nov., 1981, I found evidence of the S. 1/4 corner of SECTION 24 Township 30, North, Range 12 EAST, Fourth Principal Meridian, as described hereon; and that from this evidence I established a new monument and accessories as described hereon to perpetuate the original location of this corner.

Resident witnesses:

.....
.....
.....

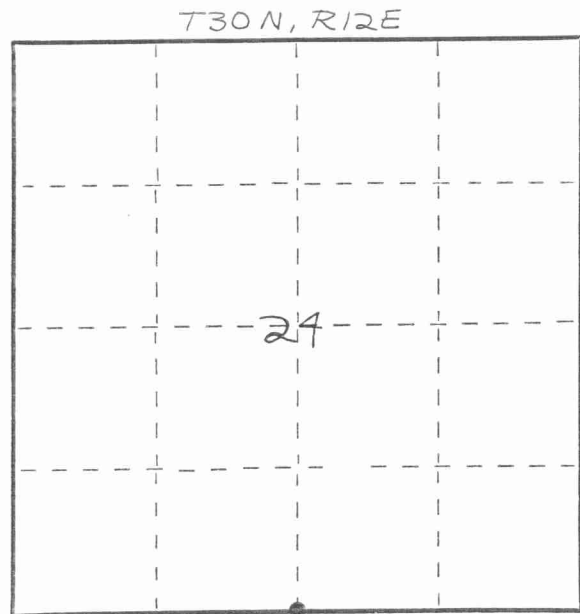

○ = Corner monument restored.

History of original corner establishment:
ORIGINAL CORNER ESTABLISHED
By JAMES WITHROW IN Nov.-Dec., 1854

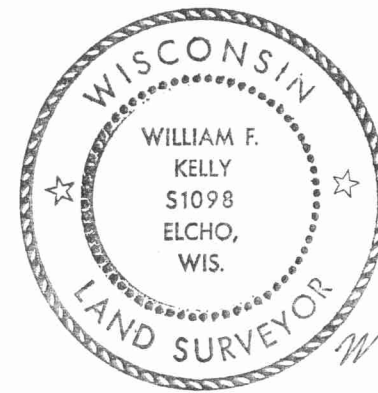

William F. Kelly

Description of corner evidence found:
ESTABLISHED CORNER AT MIDPOINT
BETWEEN SE + SW CORNERS OF SEC. 24.
SCRIBED 3 BT'S.

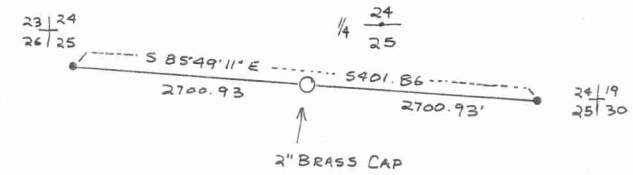

BLACK IRON PIPE WITH
SET 2" x 42" BRASS CAP MONUMENT

Description of monument and accessories I established to perpetuate the original location of this corner.

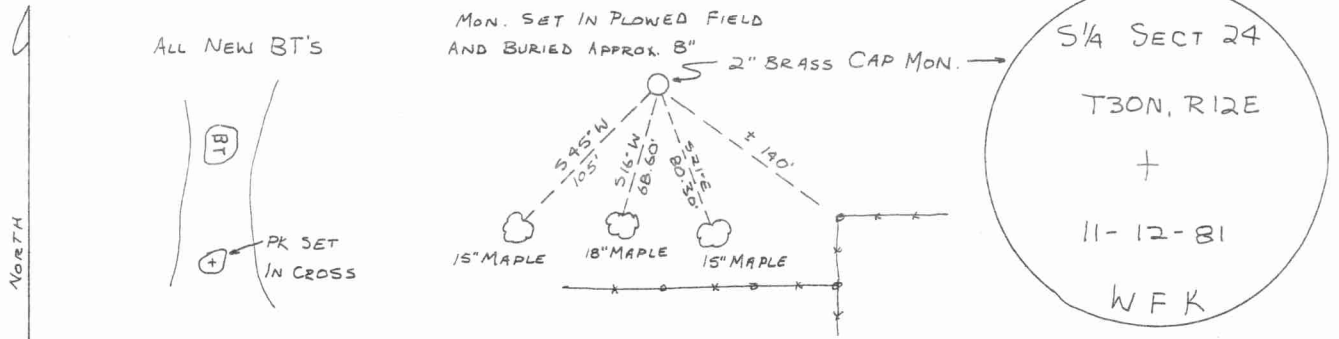

Dated at ELCHO, Wis., this 12th day of Nov., 1981.

Signature William F. Kelly Title COUNTY SURVEYOR Registration No. 1098
(County Surveyor, Registered Land Surveyor, or other duly authorized official)

Office of Register of Deeds, County of _____, I hereby certify that the within instrument was filed in this office for record on the _____ day of _____, 19____ at _____ o'clock _____ M.

(Register of Deeds)

By _____ Deputy

43012340020

FORM 985 H. C. MILLER CO., MILWAUKEE