

CERTIFIED LAND CORNER RESTORATION

Index No. P-13

State of Wisconsin }
 County of Langlade } ss.

I, Daniel K. Plegger, do hereby certify that on the 24th day of September, 1979, I found evidence of the East 1/4 corner of Section 21 Township 30, North, Range 12 East, Fourth Principal Meridian, as described hereon; and that from this evidence I established a new monument and accessories as described hereon to perpetuate the original location of this corner.

Resident witnesses:

.....

43012212000

FORM 985 R. C. MILLER CO., MILWAUKEE

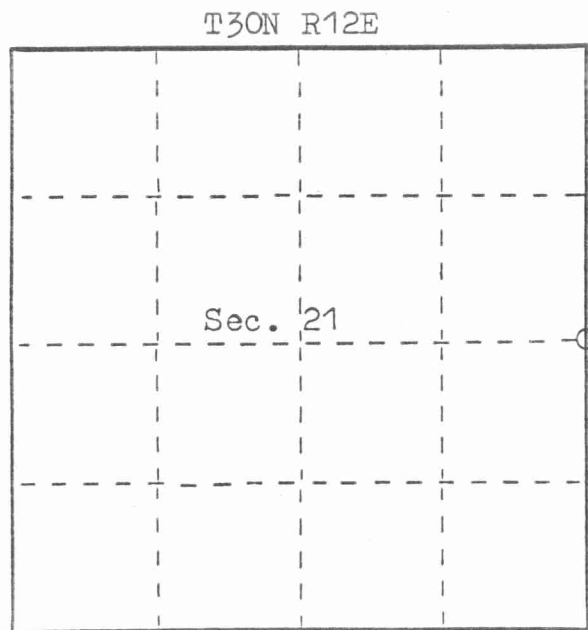

○ = Corner monument restored.

History of original corner establishment:

Description of corner evidence found:

Norwood Cemetery Plat (by Malcolm Hutchinson) shows stone in road for East 1/4 Corner of Section 21. We dug in road but could not find corner. Set 1"x30" iron pipe 33.00' north of a 3"x6" concrete monument marking the northeast corner of the Norwood Cemetery.



Description of monument and accessories I established to perpetuate the original location of this corner.

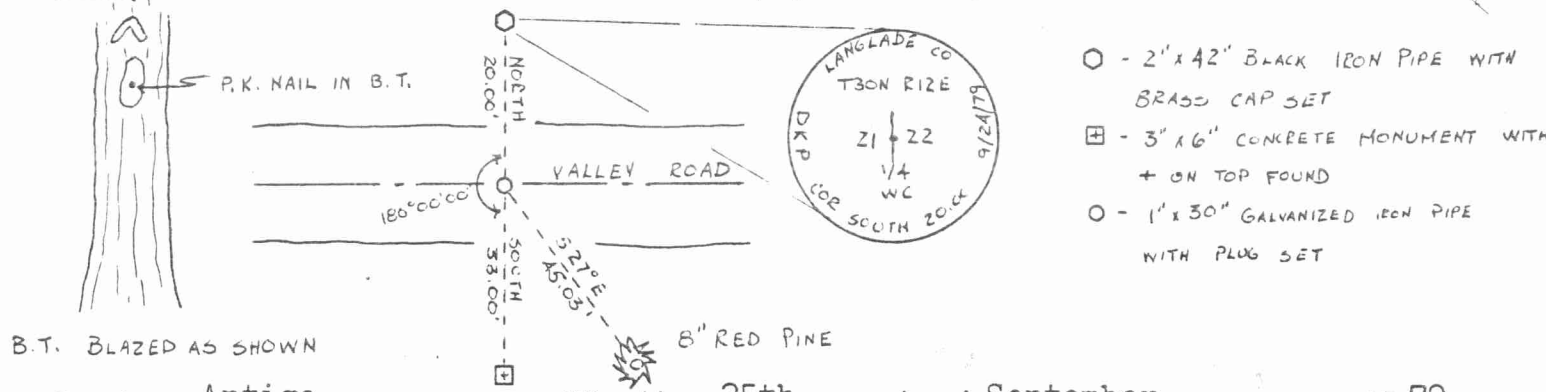

Dated at Antigo, Wis., this 25th day of September, 1979.

Signature Daniel K. Plegger Title Registered Land Surveyor Registration No. 1537
 (County Surveyor, Registered Land Surveyor, or other duly authorized official)

Office of Register of Deeds, County of....., I hereby certify that the within instrument was filed in this office for record on the..... day of....., 19..... at..... o'clock..... M.

(Register of Deeds)

By..... Deputy