

CERTIFIED LAND CORNER RESTORATION

Index No. A-14

43012039030

FORM 985 H. C. MILLER CO., MILWAUKEE

State of Wisconsin }
County of Lanola } ss.

I Raymond J. Hallisy, do hereby certify that on the 30th day of November, 1974, I found evidence of the West 1/4 corner of section 3 Township 30, North, Range 12 E, Fourth Principal Meridian, as described hereon; and that from this evidence I established a new monument and accessories as described hereon to perpetuate the original location of this corner.

Resident witnesses:

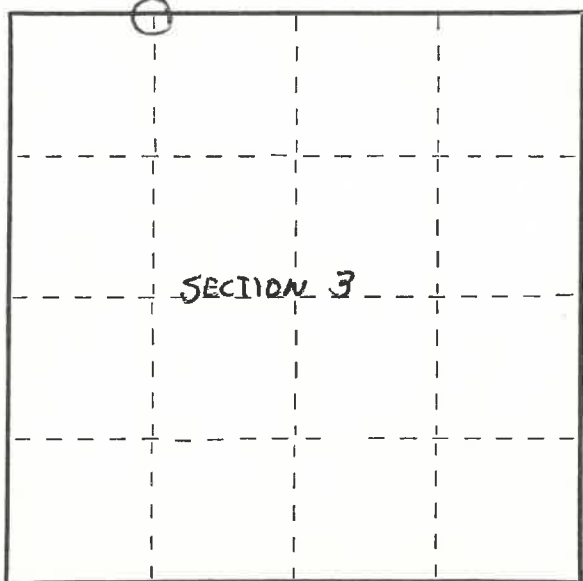

○ = Corner monument restored.

History of original corner establishment:
CORNER SET BY M. HUTCHINSON
IN 1932

Description of corner evidence found:
Squared cedar post & SCRIBED
B.T. cedar 8 S 45W 2 1/2 LKS

Description of monument and accessories I established to perpetuate the original location of this corner.

SET 1 1/2" IRON PIPE WITH BRASS CAP

New B.T.s
Cedar 10" S 23 E 22.9 LKS
Cedar 9" S 68 E 12.4 LKS

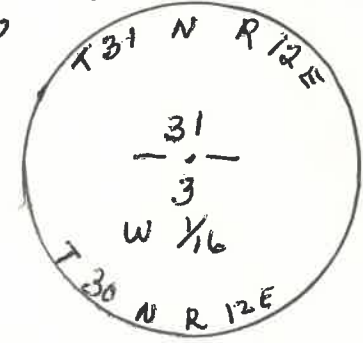

Dated at Antigo, Wis., this 30th day of November, 1974.

Signature Raymond J. Hallisy Title Reg. Land Surveyor Registration No. R.L.S-685
(County Surveyor, Registered Land Surveyor, or other duly authorized official)

Office of Register of Deeds, County of _____, I hereby certify that the within instrument was filed in this office for record on the _____ day of _____, 19____ at _____ o'clock _____ M.

(Register of Deeds)

By _____ Deputy