

4 30 11 36 00 20

FORM 985 H. C. MILLER CO., MILWAUKEE

CERTIFIED LAND CORNER RESTORATION

30-11

Index No. 2-23

State of Wisconsin }
County of LANGLADE } ss.

I ROBERT J. POSS, do hereby certify that on the 31ST day of MAY, 1969, I found evidence of the 1/4 SECTION corner of SECS. 36 & 1 Township 30 & 29, North, Range 11 EAST, Fourth, Principal Meridian, as described hereon; and that from this evidence I established a new monument and accessories as described hereon to perpetuate the original location of this corner.

Resident witnesses:
ALFRED STECK BAUER

History of original corner establishment:

AT ORIGINAL LAYING OF TOWN ROAD. A. STECK BAUER'S FATHER REFUSED TO DEDICATE 1 1/2 RDS. OF HIGHWAY LAND NEEDED. BUT BRO. IN-LAW DID TO OPEN PROPERTY IN E 1/2 SEC. 36.

Description of corner evidence found:

FOUND NO POST BUT FENCE LINES ETC. CHECK.

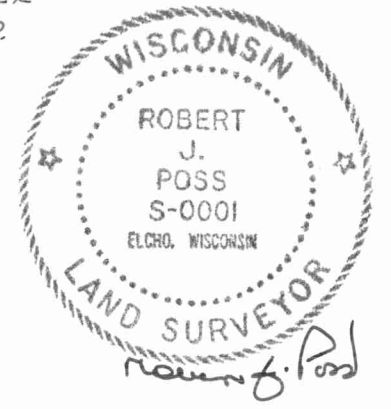

Description of monument and accessories I established to perpetuate the original location of this corner.

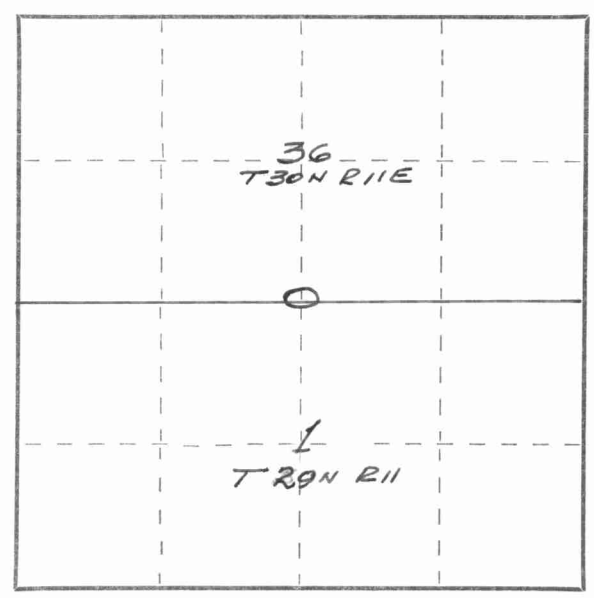
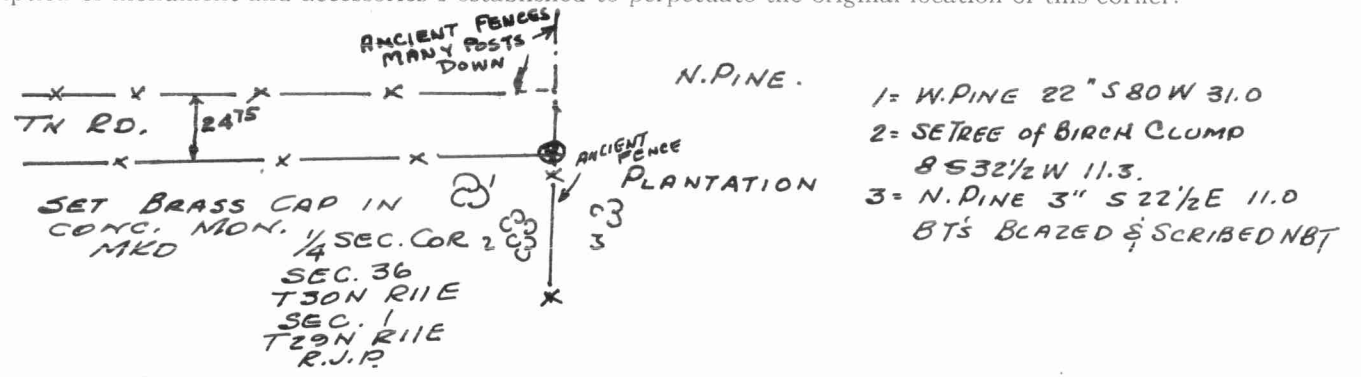

○ = Corner monument restored.

Dated at ELCHO, Wis., this 31ST day of MAY, 1969.

Signature Robert J. Poss Title REG. LAND SURVEYOR Registration No. S-0001
(County Surveyor, Registered Land Surveyor, or other duly authorized official)

Office of Register of Deeds, County of _____, I hereby certify that the within instrument was filed in this office for record on the _____ day of _____, 19____ at _____ o'clock _____ M.

(Register of Deeds)

By _____ Deputy