

CERTIFIED LAND CORNER RESTORATION

30-11

Index No. X-17

State of Wisconsin }  
County of LANGLADE } ss.

I, ROBERT J. POSS, do hereby certify that on the 24<sup>TH</sup> day of MAY, 1969, I found evidence of the 1/4 COR. corner of SECS 34 & 35 Township 30, North, Range 11 EAST., Fourth, Principal Meridian, as described hereon; and that from this evidence I established a new monument and accessories as described hereon to perpetuate the original location of this corner.

History of original corner establishment:

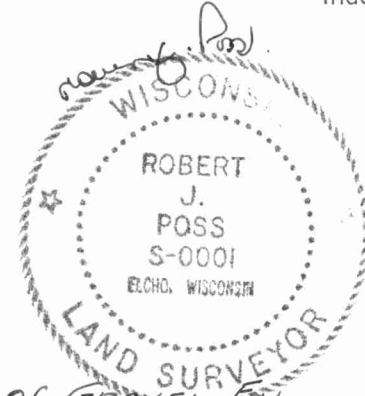

Description of corner evidence found:

CORNER IS UNDER 4' OR MORE OF GRAVEL FILL.  
ROAD WAS LAID ON LINE BY SURVEY (NO DATE)

Resident witnesses:

FRANK ANDRASCHKO (RES. OVER 60 YRS)

Description of monument and accessories I established to perpetuate the original location of this corner.

SET W. COR.  
MKD W.C.  
1/4 COR  
SEC 34 / SEC 35  
50.0' E TO COR  
SWAMP

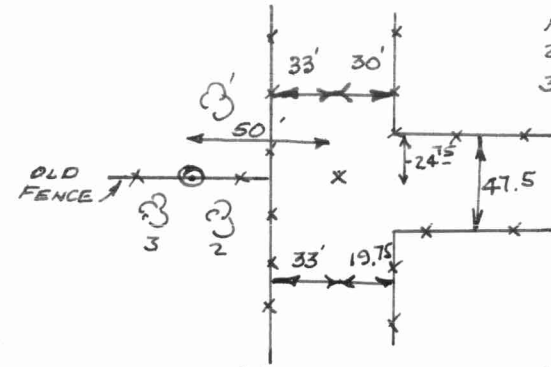

- 1- CEDAR 8 N30 E 7.4'
- 2- CEDAR 10 S 60 E 4.5
- 3- Y. BIRCH 20 S 40 1/2 W 12.2

1/4" PIPE -  
W/ BRASS CAP  
ALL TREES BLAZED  
& SCRIBED NPT  
ELCHO

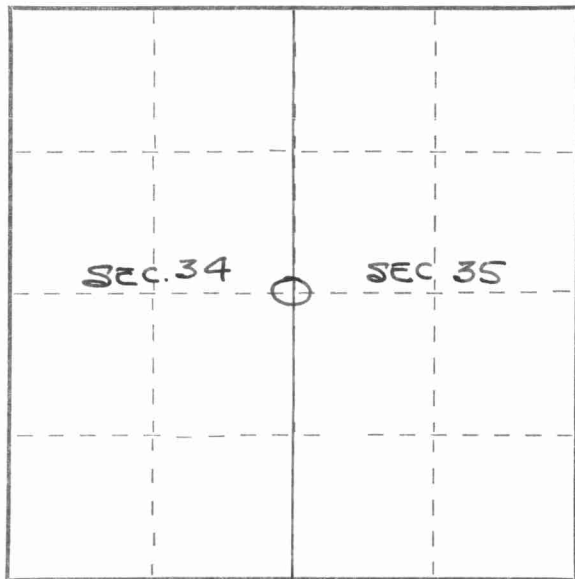

○ = Corner monument restored.

Dated at \_\_\_\_\_, Wis., this 29<sup>TH</sup> day of MAY, 1969.

Signature Robert J. Poss Title REG. LAND SURVEYOR Registration No. S-0001  
(County Surveyor, Registered Land Surveyor, or other duly authorized official)

Office of Register of Deeds, County of \_\_\_\_\_, I hereby certify that the within instrument was filed in this office for record on the \_\_\_\_\_ day of \_\_\_\_\_, 19\_\_\_\_ at \_\_\_\_\_ o'clock \_\_\_\_\_ M.

(Register of Deeds)

By \_\_\_\_\_ Deputy

FORM 995 H. C. MILLER CO., MILWAUKEE

43011342000