

4 30 11 34 00 00

FORM 985 H. C. MILLER CO., MILWAUKEE

State of Wisconsin }
County of LANGLADE } ss.

I, ROBERT J. POSS, do hereby certify that on the 31ST day of MAY, 1969, I found evidence of the SECTION corner of SECS. 34-35-2-3 Township 30 & 29, North, Range 11 EAST, Fourth, Principal Meridian, as described hereon; and that from this evidence I established a new monument and accessories as described hereon to perpetuate the original location of this corner.

Resident witnesses:

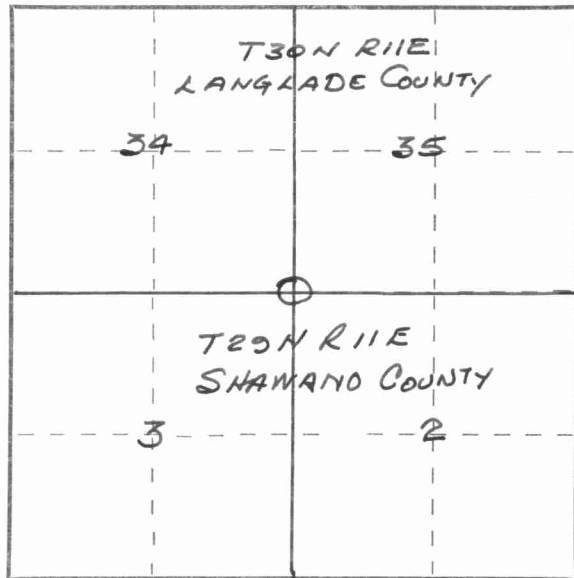

○ = Corner monument restored.

CERTIFIED LAND CORNER RESTORATION

30-11

Index No. Z-17

History of original corner establishment:

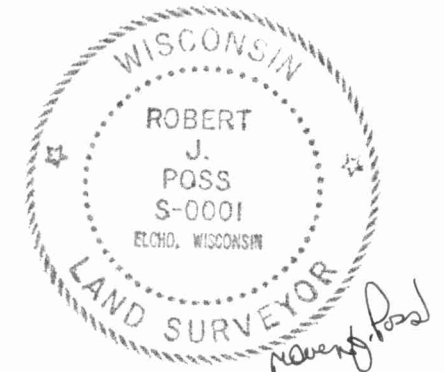

Description of corner evidence found:

FOUND SQUARED POST - NO MARKS - COMING THRU SURFACE AT INTERSECTION OF SECTION LINE; TOWN ROADS ON COUNTY LINE - POST APPROX 2' EAST 1' FT. NORTH OF ACTUAL CENTER LINES.

Description of monument and accessories I established to perpetuate the original location of this corner.

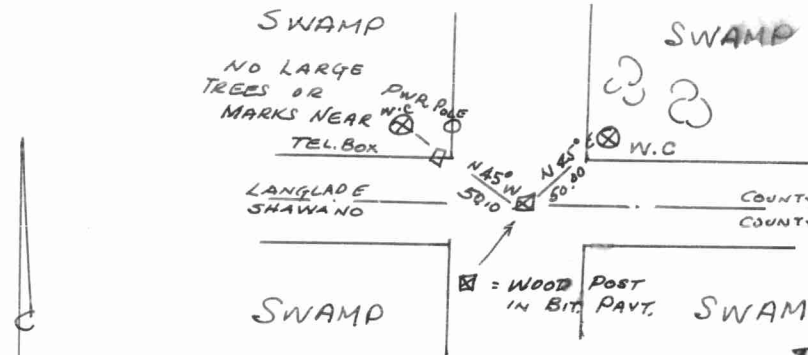

W.C. IS 1 1/2" I. PIPE PAINTED RED BRASS CAP MKD. WIT COR SEC. 34 SEC. 35 T30N R11E SEC. 3 2 SEC. 2

Dated at ELCHO, Wis., this 7TH day of JUNE, 1969

Signature Robert J. Poss Title REG. LAND SURVEYOR Registration No. S-0001
(County Surveyor, Registered Land Surveyor, or other duly authorized official)

Office of Register of Deeds, County of _____, I hereby certify that the within instrument was filed in this office for record on the _____ day of _____, 19____ at _____ o'clock _____ M.

(Register of Deeds)

By _____ Deputy