

# Government and Corner Certificate

**SHAWANO**

County

TYPE OF MONUMENT: Shawano County Berntsen

CORNER NO. 5  
 SECTION 5  
 TOWN 29 N.  
 RANGE 11 E.

STATE PLANE COORDINATES: N                     

4301132 0000

ELEVATION — M.S.L. DATUM:                     

THETA ANGLE:                     

FIELD BOOK:                      PAGE                     

DRAWN BY: Cliff Ponchaud

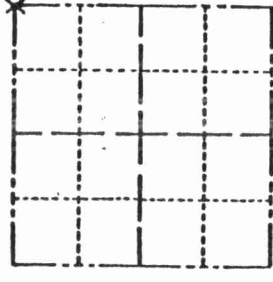

LOCATION  
(Indicated by 'X')

BASIS FOR MONUMENT LOCATION      Date of Survey: May 18, 1988.

Show info such as: History of corner, with reference to Vol. and pg., dates, surveyor; exact description of monument replaced; if location computed, by taped or EDM traverse; landowner remarks, etc. (Use reverse side if necessary)

SEAL:

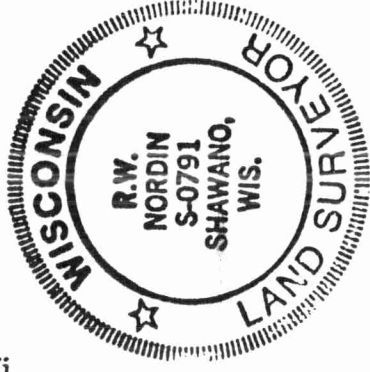

Excavated in roadway for evidence of corner, and found nothing.

Set Shawano County Berntsen Monument in line with center line Town Road to the east and fence to the south.

This position checks very well with Prior survey by J. A. Melendy of Section 4.

DATA SHOWN HERE ON  
CERTIFIED CORRECT:

*R.W. Nordin*  
 Registered Land Surveyor

DATE: May 18, 1988.

## TIE SKETCH

Show at least four ties, also fence lines, roads, topo, size and type of witness trees and if off road - best way to arrive at corner.

● DENOTES 5/8" x 24" IRON ROD SET.

BEARINGS ARE REFERENCED TO MAGNETIC NORTH.

- 'A' = N. 26° 00' E. 113.76'
- 'B' = N. 51° 55.0' E. 144.42'
- 'C' = S. 26° 00' W. 50.10'
- 'D' = N. 63° 03.5' W. 44.27'
- 'E' = 65.15' 'G' = 67.40'
- 'F' = 190.74' 'H' = 121.39'

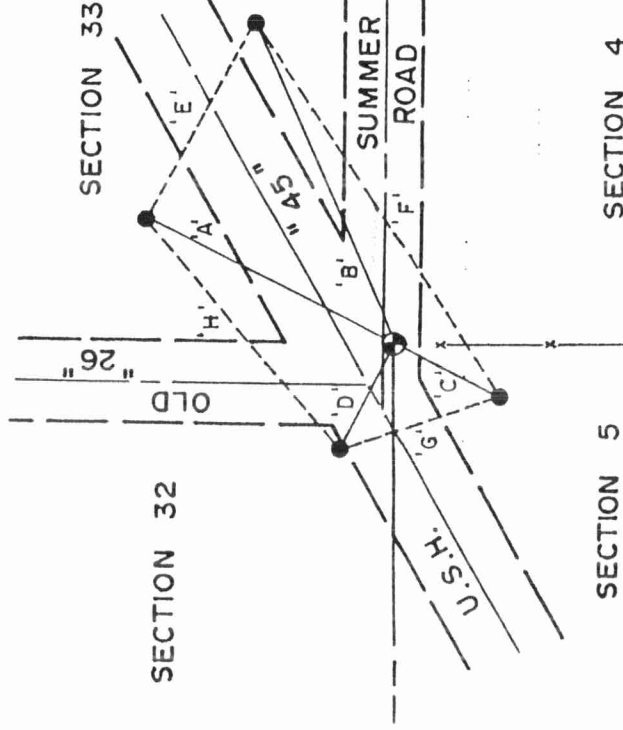

29 30-11