

CERTIFIED LAND CORNER RESTORATION

Index No. V-10

State of Wisconsin }  
County of LANGLADE } ss.

I WILLIAM F. KELLY, do hereby certify that on the 12<sup>th</sup> day of JAN., 19 82, I found evidence of the W 1/8 corner of on S. Line, SEC. 28 Township 30, North, Range 11 EAST, Fourth Principal Meridian, as described hereon; and that from this evidence I established a new monument and accessories as described hereon to perpetuate the original location of this corner.

Resident witnesses:

.....  
.....  
.....

History of original corner establishment:  
ORIGINAL CORNER ESTABLISHED BY  
WM. T. BRADLEY IN. OCT., 1853.

Description of corner evidence found:  
SET A 1 1/2" x 42" BLACK IRON PIPE  
WITH BRASS CAP MONUMENT.



Description of monument and accessories I established to perpetuate the original location of this corner.

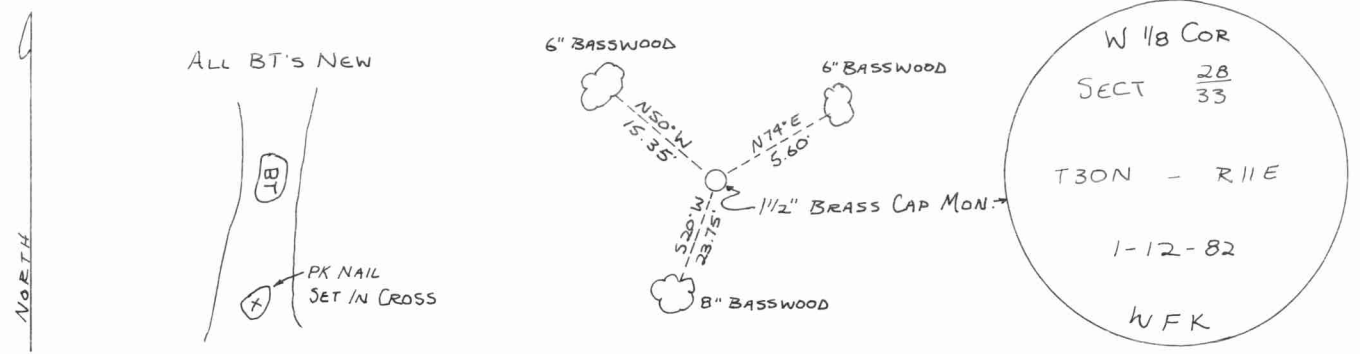
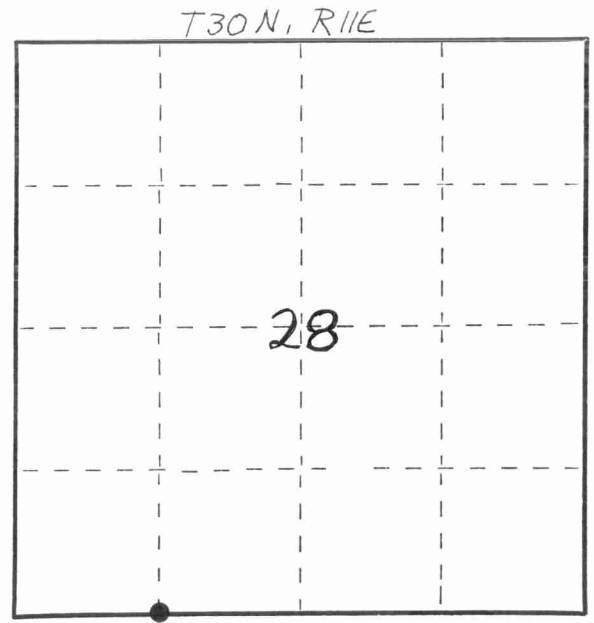

Dated at ELCHO, Wis., this 12<sup>th</sup> day of JANUARY, 19 82.

Signature William F. Kelly Title COUNTY SURVEYOR Registration No. 1098  
(County Surveyor, Registered Land Surveyor, or other duly authorized official)

Office of Register of Deeds, County of....., I hereby certify that the within instrument was filed in this office for record on the..... day of....., 19..... at..... o'clock..... M.

.....  
(Register of Deeds)

By..... Deputy

FORM 985 H. C. MILLER CO., MILWAUKEE  
4201250030

○ = Corner monument restored.