

CERTIFIED LAND CORNER RESTORATION

Index No. V-13

State of Wisconsin }
County of LANGLADE } ss.

I WILLIAM F. KELLY, do hereby certify that on the 25th day of Nov., 1981, I found evidence of the SE corner of SECT 28 Township 30, North, Range 11 EAST, Fourth Principal Meridian, as described hereon; and that from this evidence I established a new monument and accessories as described hereon to perpetuate the original location of this corner.

Resident witnesses:

S. Kassler

History of original corner establishment:
ORIGINAL CORNER ESTABLISHED BY WILLIAM BRADLEY IN OCT., 1853.

Description of corner evidence found:

3" x 3" CEDAR POST, FOUND IN PLACE.
SET A 2" x 42" BLACK IRON PIPE WITH BRASS CAP MONUMENT AS CORNER.

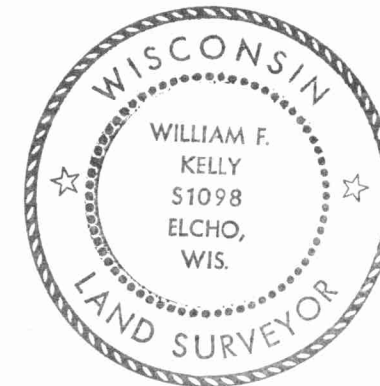

Description of monument and accessories I established to perpetuate the original location of this corner.

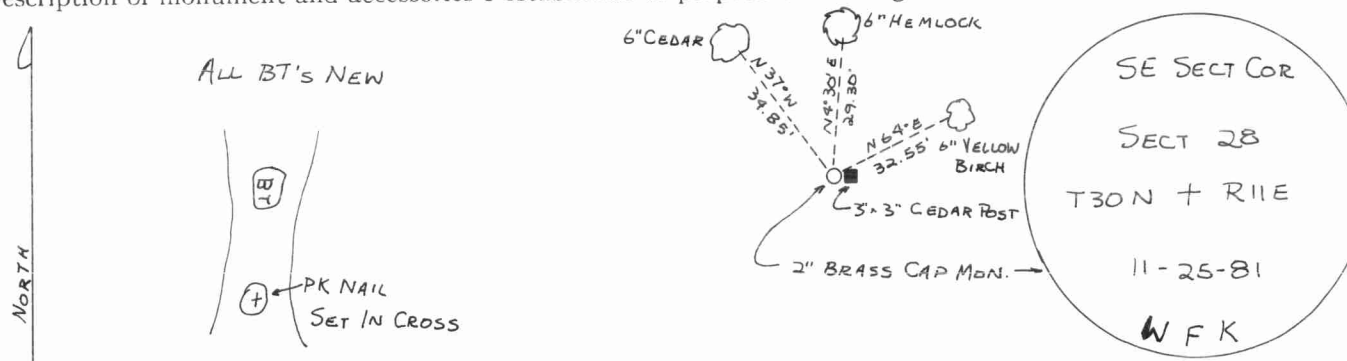

Dated at ELCHO, Wis., this 25th day of Nov., 1981.

Signature William F. Kelly Title COUNTY SURVEYOR Registration No. 1098
(County Surveyor, Registered Land Surveyor, or other duly authorized official)

Office of Register of Deeds, County of _____, I hereby certify that the within instrument was filed in this office for record on the _____ day of _____, 19____ at _____ o'clock _____ M.

(Register of Deeds)

By _____ Deputy

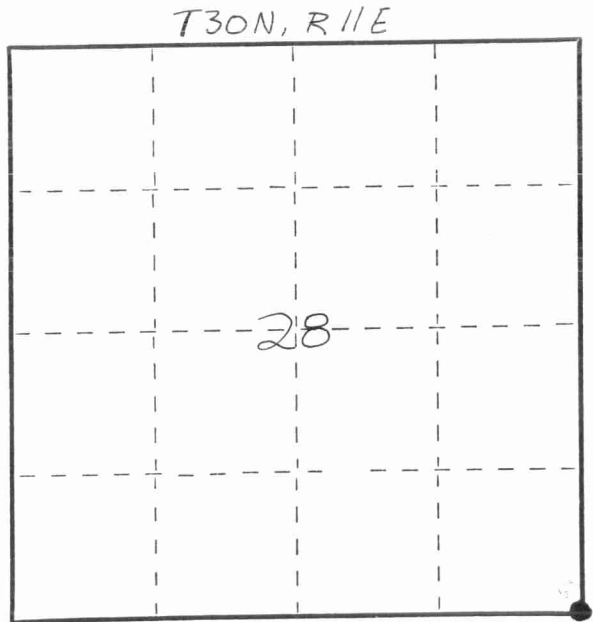

○ = Corner monument restored.

FORM 985 H. C. MILLER CO., MILWAUKEE 4301128000