

430 11 25 2000

U. S. PUBLIC LAND SURVEY MONUMENT RECORD

INSTRUCTIONS:

This record shall show the location of the corner and shall include all of the following nine elements (a through i).

- (a) Identify the corner by reference to the U.S. public land survey system.
- O = Corner monument restored.

ORIGINAL CORNER SET BY
 WM. T. BRADLEY
 MAY, 1853

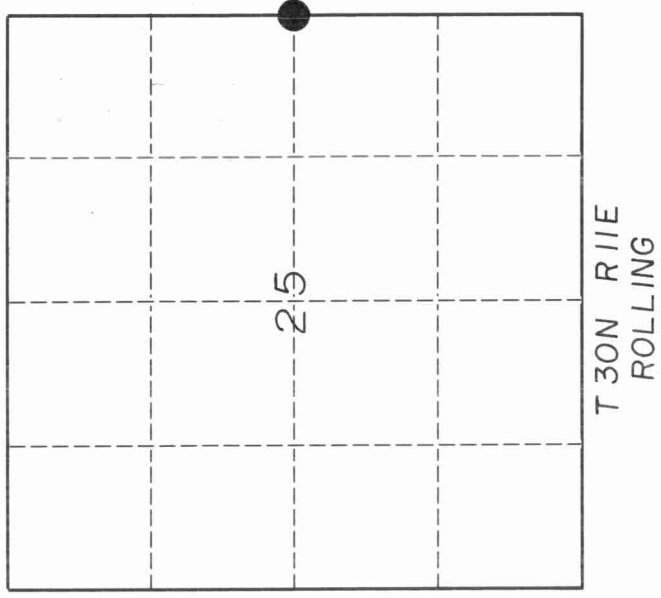

- (b) Describe any record evidence, monument evidence, occupational evidence, testimonial evidence or any other material evidence you considered, and whether the monument was found or placed.

Found 3/4 inch Iron Pipe presumably placed or found by W.F. Kelly in 1987. He placed a 3 inch Aluminum Witness Monument identifying the corner in July of 1987. No tie sheet could be found on this corner. I accepted the 3/4 inch pipe found as best evidence for this corner location.

- (c) In the plan view drawing below, provide reference ties to at least 4 witness monuments, or, if the location is within a municipality, to at least 2 witness monuments. (Witness monuments shall be made of concrete, natural stone, iron or other equally durable material.) Describe witness monuments.

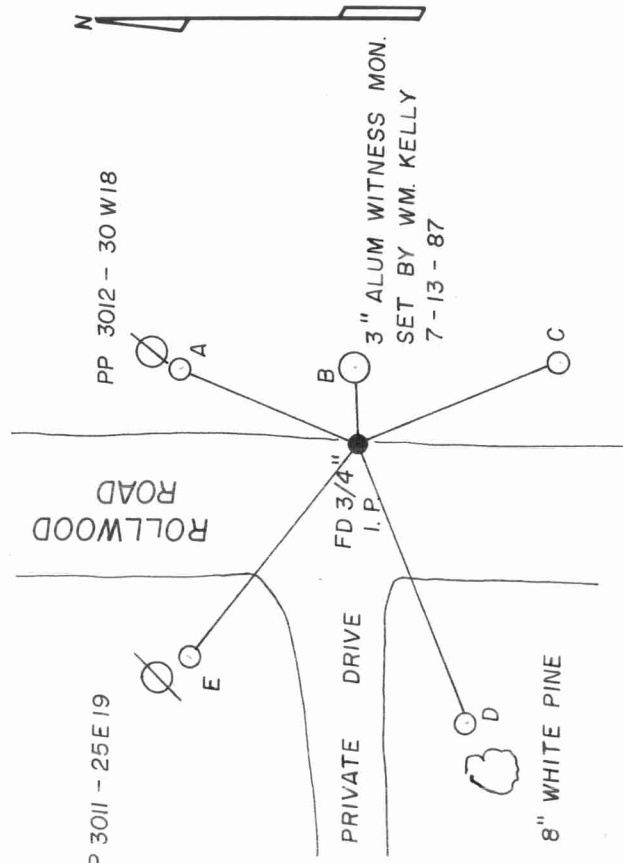

PP 3011 - 25E 19

PP 3012 - 30 W18

TIES

A	N 22° 59' 30" E	30.55'
B	N 87° 24' 45" E	12.02'
C	S 22° 28' 30" E	33.77'
D	S 67° 56' 30" W	46.46'
E	N 51° 07' 30" W	42.73'

SCALE: 1" = 30'

T25
 30-11

Describe any material discrepancy between the location of the corner as restored or reestablished and the location of that corner as previously restored or reestablished by distance and direction. Show the discrepancy on the plan view drawing under (d), above. Show the distances between the corner as previously restored or reestablished and (1) the corner as restored or reestablished, and (2) to at least 2 of the witness monuments shown on the drawing in (d), above.

(f) Was the corner restored through acceptance of (1) an obliterated evidence location, or, (2) a found perpetuated location.?

(g & h) Was the corner reestablished through lost corner proportionate methods? If so, show the method, including the directions and distances to other public land survey corners used as evidence or used for proportioning in determining the corner location.

(i) I, Daniel E. Higginbotham
(type or print name)

certify that the corner location shown on this record was determined by me or under my direction and control and that this U.S. Public Land Survey Monument Record is correct and complete to the best of my knowledge and belief.

Signature

June 9, 1992
Date

