

CERTIFIED LAND CORNER RESTORATION

Index No. V-25
30-11

State of Wisconsin }
County of Langlade } ss.

I Edwin R. Abendroth do hereby certify that on the 10th day of July, 1980, I found evidence of the Northwest corner of Section 31 Township 30, North, Range 12 East, Fourth, Principal Meridian, as described hereon; and that from this evidence I established a new monument and accessories as described hereon to perpetuate the original location of this corner.

Resident witnesses:
.....
.....
.....

History of original corner establishment:
Original Survey conducted, started November, 1854 finished December 1854 by James Withrow, deputy Surveyor, found no original evidence as per original government notes.

Description of corner evidence found:
Found railroad spike at centerline intersection, presumed to be corner.
Origin unknown.

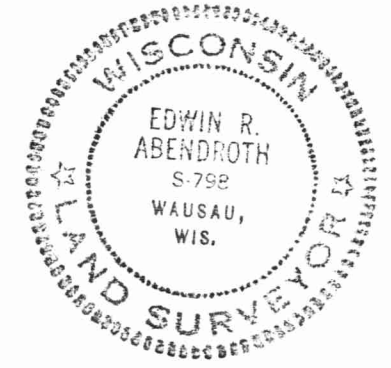

Description of monument and accessories I established to perpetuate the original location of this corner.

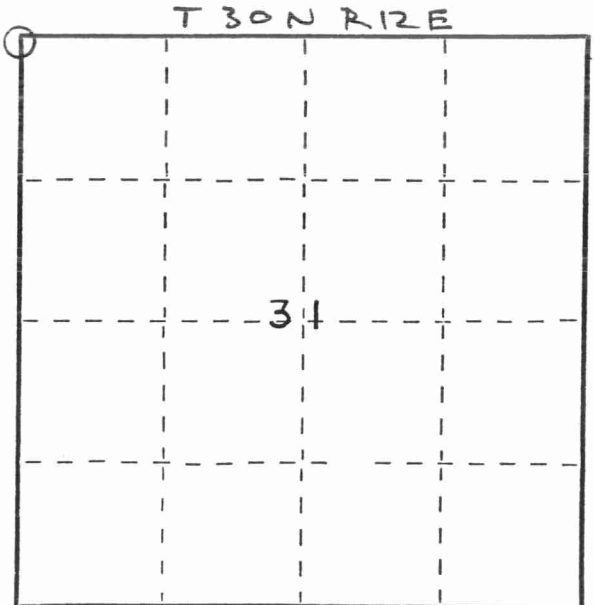
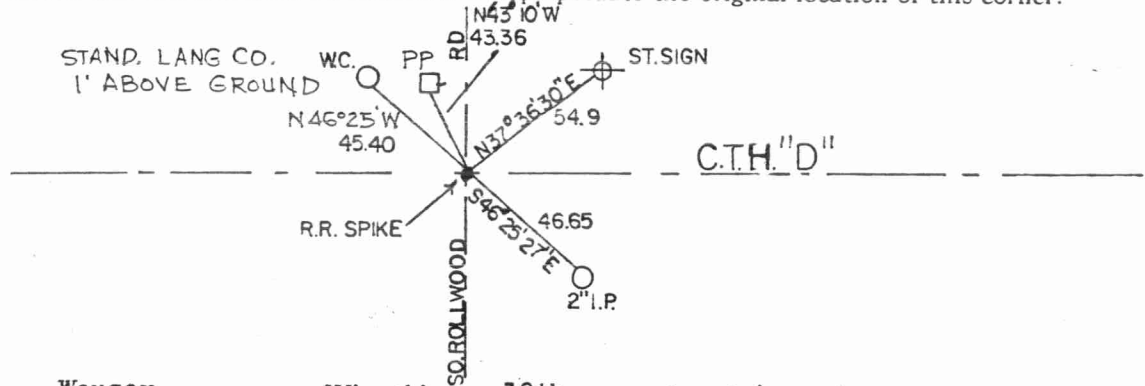

○ = Corner monument restored.

Dated at Wausau, Wis., this 12th day of August, 1980.

Signature Edwin R. Abendroth Title Registered Land Surveyor Registration No. S-798
(County Surveyor, Registered Land Surveyor, or other duly authorized official)

Office of Register of Deeds, County of....., I hereby certify that the within instrument was filed in this office for record on the..... day of....., 19..... at..... o'clock..... M..

.....
(Register of Deeds)

By..... Deputy

4301125 0000