

CERTIFIED LAND CORNER RESTORATION

Index No. P-1

State of Wisconsin }  
County of LANGLADE } ss.

History of original corner establishment:

U. S. GOV'T. FIELD NOTES.



43012242000

I, R. W. NORDIN, do hereby certify that on the 21ST day of JUNE, 19 79, I found evidence of the WEST QUARTER corner of SECTION 19 Township 30, North, Range 12 EAST, Fourth Principal Meridian, as described hereon; and that from this evidence I established a new monument and accessories as described hereon to perpetuate the original location of this corner.

Description of corner evidence found:

EXCAVATED FOR CORNER. FOUND EVIDENCE OF DECAYED POST AT FENCE CORNER.

Resident witnesses:

S. R. NORDIN

TIM WOLF

JOE HOLLRITH

Description of monument and accessories I established to perpetuate the original location of this corner.

SET A 2" X 36" IRON PIPE WITH BRASS CAP FOR CORNER.  
(SEE REVERSE SIDE FOR TIES.)

FORM 985 H. C. MILLER CO., MILWAUKEE

T-30 N R 12 E

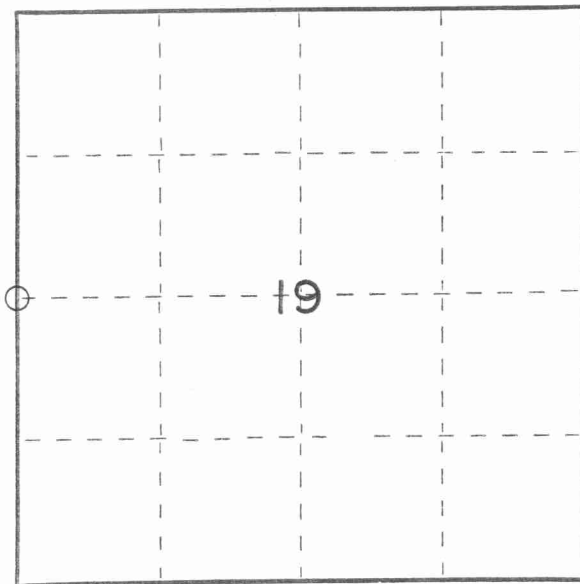

○ = Corner monument restored.

Dated at SHAWANO, Wis., this 25TH day of JUNE, 19 79.

Signature R. W. Nordin Title LAND SURVEYOR Registration No. S-791  
(County Surveyor, Registered Land Surveyor, or other duly authorized official)

Office of Register of Deeds, County of \_\_\_\_\_, I hereby certify that the within instrument was filed in this office for record on the \_\_\_\_\_ day of \_\_\_\_\_, 19 \_\_\_\_\_ at \_\_\_\_\_ o'clock \_\_\_\_\_ M.

(Register of Deeds)

By \_\_\_\_\_ Deputy

43018240020

1/4/1914

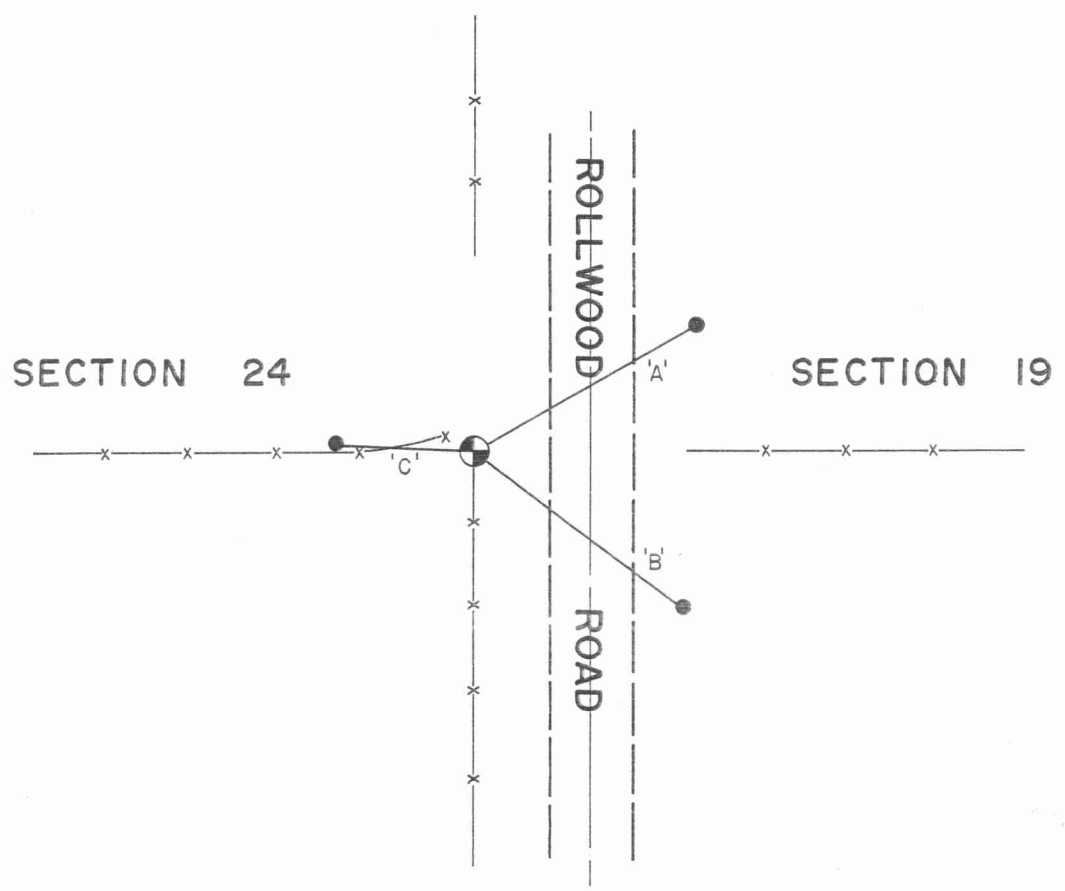

● DENOTES 1" IRON PIPE SET.  
BEARINGS ARE MAGNETIC.

- 'A' = N. 60° - 32' E. 66.68'
- 'B' = S. 53° - 47' E. 67.93'
- 'C' = N. 87° - 58' W. 36.07'