

MARATHON COUNTY U.S. PUBLIC LAND  
SURVEY MONUMENT LOCATION RECORD

SECTION 13  
TOWNSHIP 30N  
RANGE 10E

91  
NO.

LANDMARK  BENCHMARK  FOUND  SET   
CORNER IDENTITY: S.E. COR. 5/8" BOD RE - SET   
STATE PLANE COORDINATE: N: \_\_\_\_\_ RE - TIED

HARRISON TOWN

SECTION 430101300 90

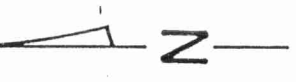
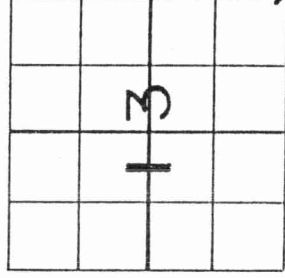

ZONE: \_\_\_\_\_ E: \_\_\_\_\_  
ELEVATION - (FEET): \_\_\_\_\_ DATUM: \_\_\_\_\_  
THETA ANGLE: \_\_\_\_\_ WEATHER: \_\_\_\_\_  
DATE OF SURVEY: 4-26-95 TEMPERATURE: \_\_\_\_\_ °F  
SURVEY PARTY: CHET NOWACZYK KEN GRAYKOWSKI

**BASIS FOR MONUMENT LOCATION:**  
(DESCRIBE METHOD OF SURVEY AND CORNER AUTHENTICATION)

4301130000

Original found and tied by me on 7/19/1984. SEAL



CERTIFIED CORRECT Chet Nowaczyk

FIELD BOOK NO. \_\_\_\_\_ PAGE NO. \_\_\_\_\_

DATE: June 2, 1995

**TIE SKETCH:** SHOW MINIMUM OF FOUR (4) HORIZONTAL TIE DISTANCES TO FIXED WITNESS MONUMENTS.  
DESCRIBE ALL MONUMENTS FOUND OR SET. CORRECT ALL DISTANCES SHOWN TO STANDARD TEMPERATURE OF 68° F.

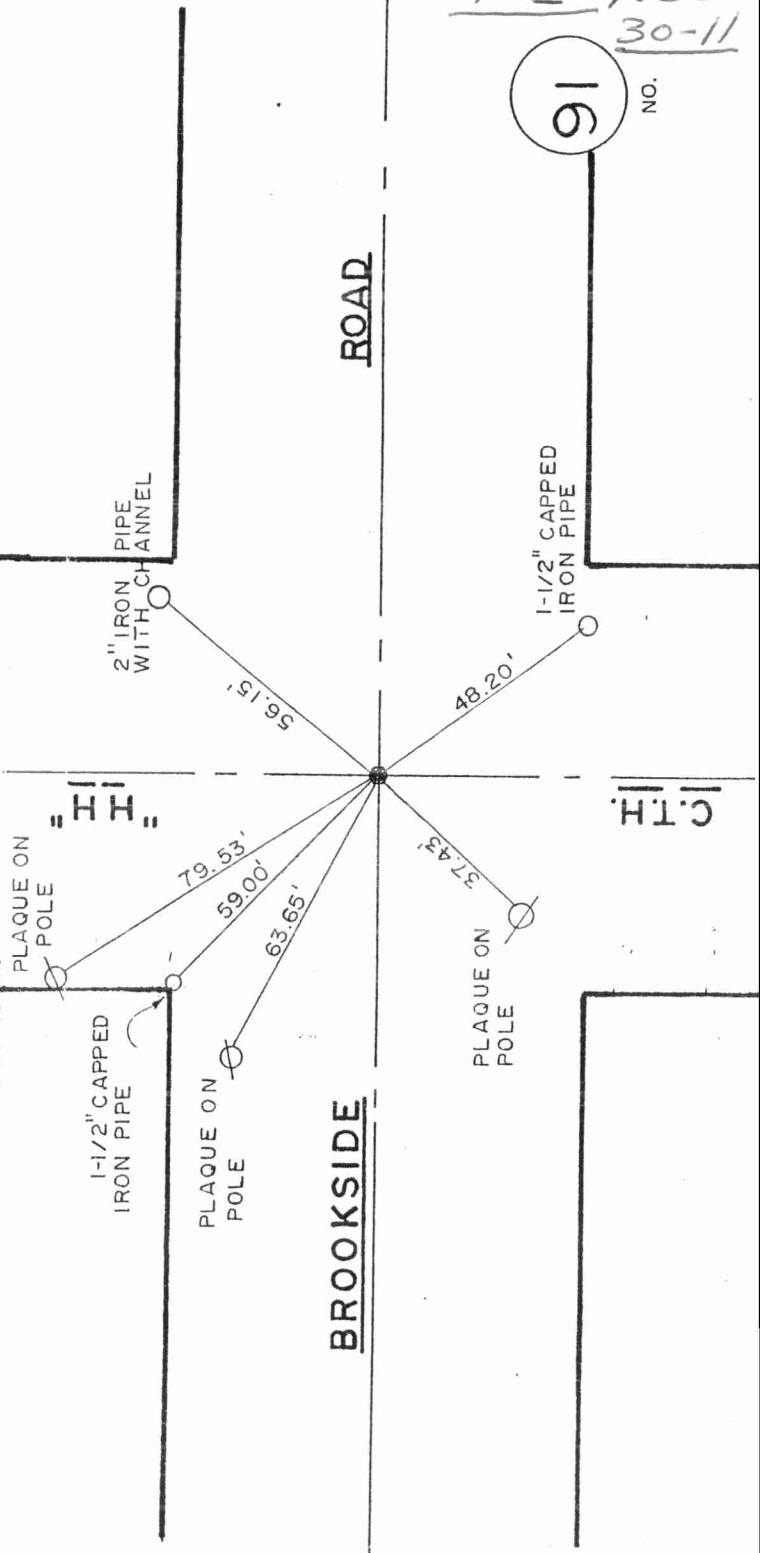

N1 N25  
30-11

91  
NO.