

SURVEY MONUMENT LOCATION RECORD

LANDMARK: BENCHMARK FOUND
CORNER IDENTITY: R.R. SPIKE W/ X SET
STATE PLANE COORDINATE: N: RE-SET
ZONE: E: RE-TIED

ELEVATION-(FEET): DATUM:
THETA ANGLE: WEATHER: SUNNY
DATE OF SURVEY: 3-11-93 TEMPERATURE: 18 F
SURVEY PARTY: MD ES BH

BASIS FOR MONUMENT LOCATION
(DESCRIBE METHOD OF SURVEY AND CORNER AUTHENTICATION)

SEARCHED AREA FOR CORNER AND FOUND RAILROAD SPIKE IN CENTERLINE INTERSECTION OF COUNTY TRUNK ROADS. (EXCEPT) THIS POSITION AS TEMPORARY SECTION CORNER AND TIED THE SAME.

ACCEPTED ?

DRAWN BY: MICHAEL C. REBMAN
COMPANY: NORDIN & ASSOCIATES, INC.

TIE SHEET

SHOW MINIMUM OF FOUR (4) HORIZONTAL TIE DISTANCES TO FIXED WITNESS MONUMENTS. DESCRIBE ALL MONUMENTS FOUND OR SET. CORRECT ALL DISTANCES SHOWN TO STANDARD TEMPERATURE OF 68° F.

LEGEND AND NOTES

- ▲ DENOTES GPS POINT
- DENOTES 5/8" x 24" IRON ROD SET
- ⊢ SIGN POST

- A = N43°22'49"E 71.14'
- B = S26°16'10"E 93.09'
- C = S43°22'49"W 64.32'
- D = N26°16'10"W 87.85'
- E = S26°16'10"E 28.39'

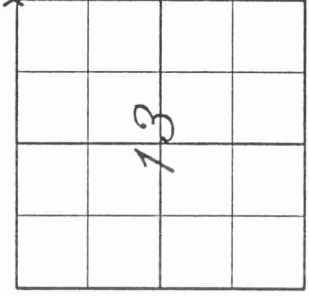
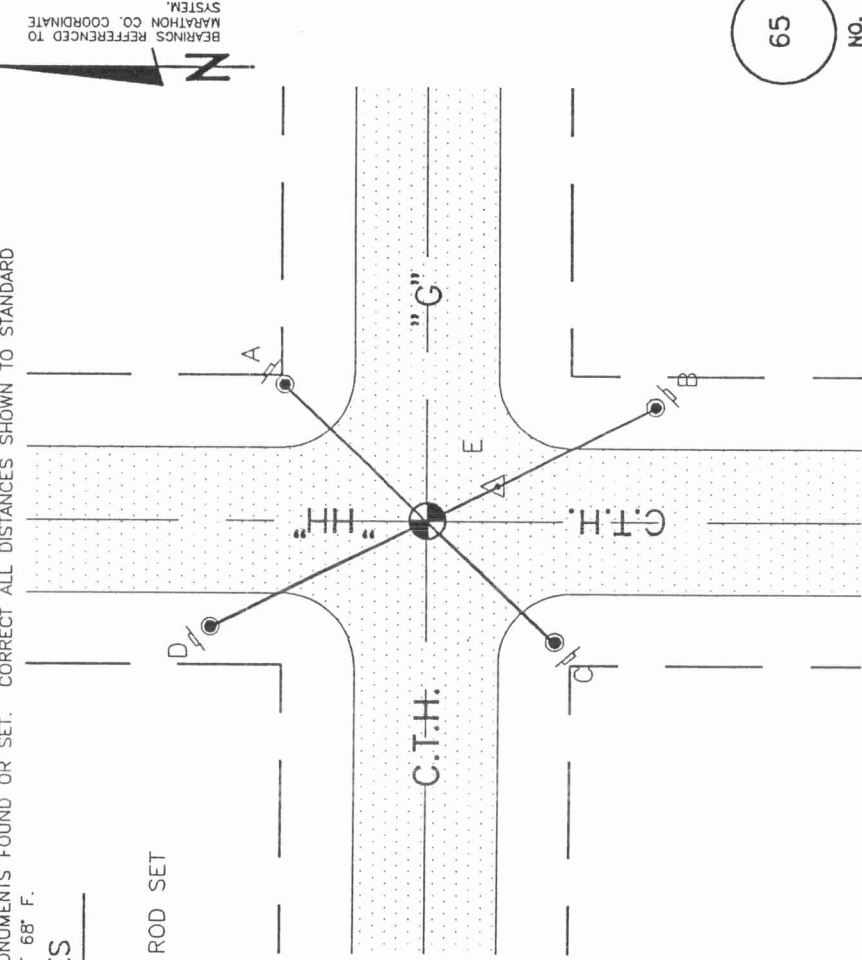

LOCATION (Indicated by 'X')
SEAL:



CERTIFIED CORRECT:
M. J. Nordin
Registered Land Surveyor
DATE: 3-11-1993

65

A15

NO.

SECTION: 65
TOWN: 30
RANGE: 10
TOWNSHIP: HARRISON

43010120000

65

A15

NO.

30-11 J1

